

GENERAL NOTES

- 1)THIS DRAWING IS COPYRIGHT RESERVED AND REMAINS THE PROPERTY OF SKCM.
2)ALL DRAWINGS TO BE READ IN CONJUNCTION WITH THE ARCHITECTS DRAWINGS.
3)ALL WORK TO BE EXECUTED IN STRICT COMPLIANCE WITH SANS 10400 & SABS 1200.
4)ALL DIMENSIONS TO BE CHECKED ON THE SITE AND ANY DISCREPANCIES TO BE REPORTED TO THE ARCHITECTS/ ENGINEER IMMEDIATELY BEFORE COMMENCING WITH ANY WORK.
5)WRITTEN DIMENSIONS TO BE USED IN PREFERENCE TO SCALED DIMENSIONS.
6)DRAWINGS MAY NOT BE SCALED FROM PRINTS DUE TO DISTORTION OF PRINTS.

Platform Legend

- Natural Ground Level
Strip 800mm
Shattered Sandstone Layer
Hardrock Platform Level
Final Platform Level

NO	DATE	AMENDMENT
T00	2023/05/24	ISSUED FOR TENDER.

COPYRIGHT IS VESTED IN THIS DOCUMENT AND NO USE OR REPRODUCTION OR DUPLICATION THEREOF MAY OCCUR WITHOUT THE WRITTEN CONSENT OF THE AUTHOR.



architects
MPANDE CONSULTANTS



project
**DOE Portfolio Programme
ESTABLISHMENT OF
HILLBROW SCHOOL**

drawing title
**SSS
SITE CROSS SECTION
FOUR**

scale	designed
1:500 (A1)	HJV
date	drawn
24 OCT 2022	HJV
status	checked
TENDER	MLX
discipline	EMS
CE/SE	200500494
drawing number	revision
F0279 - 004	TDO

CH.150

H SCALE 1:200
V SCALE 1:200

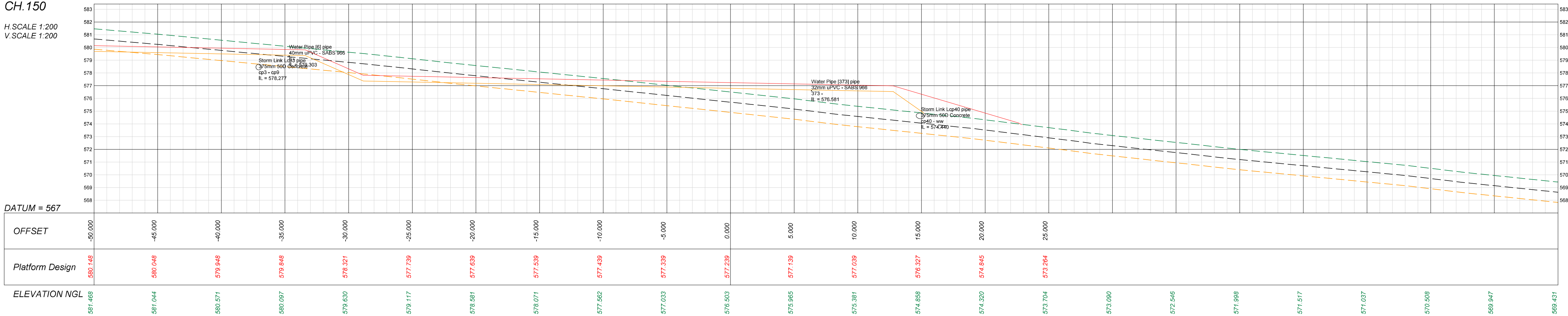

CH.100

H SCALE 1:200
V SCALE 1:200

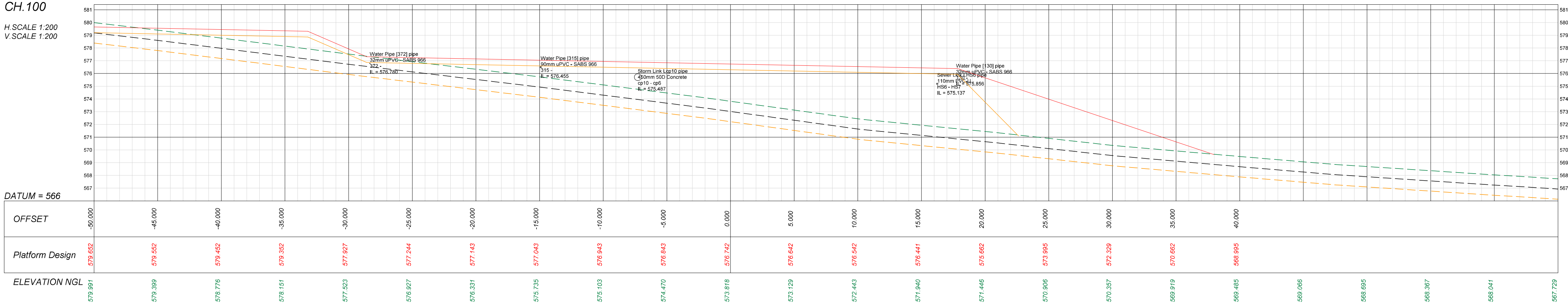

CH.50

H SCALE 1:200
V SCALE 1:200

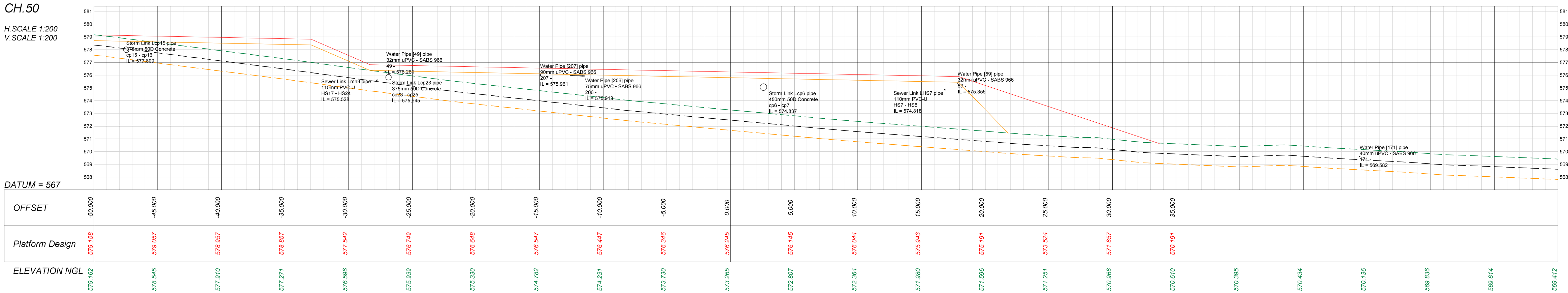

SITE CROSS SECTION FOUR